



CORiTEC 150i series

The CORiTEC 150i series

WHAT ARE THE DIFFERENCES?

| | CORTEC 150i PRO | CORTEC 150i dry | CORTEC 150i dry eco |
|-----------------------------|-----------------|-----------------|----------------------|
| PC | integrated | integrated | external PC required |
| Touchscreen | ✓ | ✓ | - |
| Integrated PC | ✓ | ✓ | - |
| Premilled Abutments | ✓ (CoCr/Ti) | ✓ (CoCr) | ✓ (CoCr) |
| Wet processing | ✓ | - | - |
| Dry processing | ✓ | ✓ | ✓ |
| Metal processing** | ✓ | ✓ | ✓ |
| Integrated water tank | ✓ | - | - |
| Ionizer | ✓ | ✓ | optional |
| Auto calibration* | ✓ | ✓ | ✓ |
| Chip tray | - | ✓ | optional |
| 98mm blank holder | ✓ | ✓ | ✓ |
| 6-fold glass ceramic holder | optional | - | - |



The new features...



Minimum compressed air requirement



Integrated ionizer



Auto calibration*



Automated cleaning function*



Large number of holder systems



Metal processing**

WHETHER WET OR DRY MACHINING, BLOCK OR BLANK FORM, THE CORiTEC 150i SERIES IMPRESSES IN ALL AREAS.

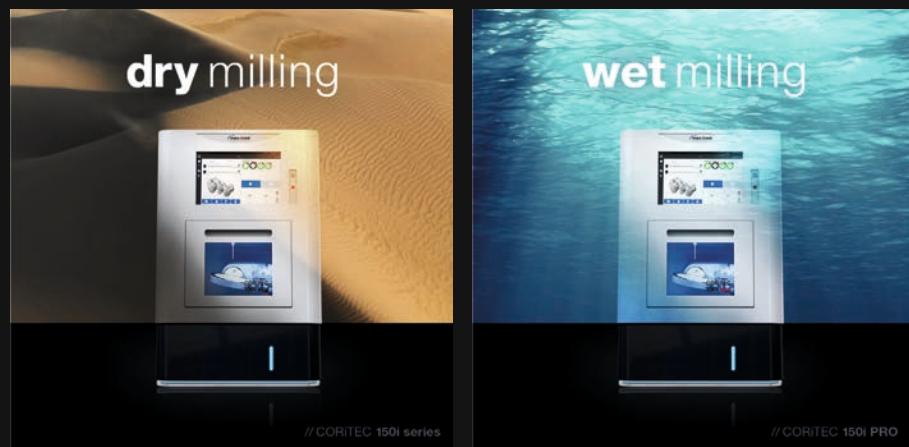

Each restoration is fabricated with optimum precision and, at the same time, the flexibility opens up an almost free choice of materials and indications. Milling and grinding of zirconium, plastics and metal** is possible, as is the machining of CAD/CAM blocks and Pre-milled abutments. The CORiTEC 150i offers an unrivalled variety of applications in a very small space.

UNLIMITED FLEXIBILITY IN MILLING AND GRINDING – THAT'S THE PROMISE OF THE CORiTEC 150i SERIES



Thanks to a machining angle of up to 360°/130° (A-axis/B-axis), the system is able to effortlessly master even the most demanding tasks. The 10 tool places additionally increase the flexibility of the new CORiTEC 150i series.

*In preparation | **Limited metal processing in preparation



The new features...

NEW
FEATURES

MORE PERFORMANCE,
MAXIMUM FLEXIBILITY AND
EXTENDED APPLICATION
POSSIBILITIES WITH MINIMAL
SPACE REQUIREMENTS

An exceptional ratio of power, speed and precision – this is what the powerful high-frequency spindle with 750 W and 100.000 rpm offers. Thanks to the quick-clamping system, the various holder systems can be changed quickly and easily – while maintaining the same precision. Time-consuming calibrations are therefore unnecessary.



A VARIETY OF
HOLDING SYSTEMS
OFFERS MAXIMUM
FLEXIBILITY FOR
MAXIMUM CHALLENGES

Also new is the support of the half-open blank holder, the so-called "C-Clamp". Thanks to its open shape, it allows even the most difficult indications to be produced.



CORiTEC 150i PRO

THE FLEXIBLE MILLING SYSTEM IN CONFINED SPACES

The extremely stable design of the mono-block cast body enables precise machining with round blanks and block forms. The machine's small dimensions and 5-axis simultaneous technology offers a unique ratio of machine size and functionality. Convince yourself of the performance of the CORiTEC 150i for your laboratory!

Available in three versions:



CORiTEC
150i PRO



CORiTEC
150i dry



CORiTEC
150i dryeco



- WET
- DRY
- 5 AX
- 3mm 10x
- Temperature control
- Touch screen
- Connectivity
- Wash cycle
- ION

CORiTEC 150i PRO

HIGHLIGHTS

- novel, closed mono-block cast body for highest stability and precision
- no external PC required
- half-open blank holder "C-Clamp" (optional)
- ionizer inclusive
- high precision due to integrated temperature compensation
- wet and dry machining possible
- minimum external compressed air, only 3 bar required
- short amortization period
- minimal footprint
- auto calibration*
- automated cleaning function*
- metal processing**
- turn-milling-grinding-processing possible

*In preparation | **Limited metal processing in preparation



| | | | | | | | | |
|----------------|------------------|----------|--------------------|------------------------|---------------|-----------------------|-------------------|------------------|
| PMMA | WAX | Standard | PreMilled Abutment | Dentures | Crown, Bridge | Inlay, Onlay Veneer | Hybrid Abutment | Splint |
| Zr | COMPOSITE | | | | | | | |
| PEEK | SINT | C-Clamp | Block | Manual clamping system | Full Denture | Model | Drilling template | Model casting |
| Glass-ceramics | PreFab Abutments | | | | | | | |
| CoCr | Ti | | | | Bridge | Telescopic technology | Abutment | Hybrid machining |
| | | | | | | | | |

T1/T6 - 3.0 | 3.0 mm
radius milling tool (l = 15 mm)

| | |
|----|------|
| T1 | Ti |
| T6 | CoCr |

3.0 mm Ø 3 mm

up to 15 mm ↑

Blades

Art.-No. 526029 3003

T11/T13 - 2.5 | 3.0 mm
radius milling tool

| | |
|-----|------|
| T11 | PMMA |
| | WAX |
| T13 | Zr |

2.5 mm Ø 3 mm

up to 25 mm ↑

Blades

Art.-No. 526016 2503

T16 - 1.5 | 3.0 mm
radius milling tool (l = 15 mm)

| | |
|-----|------|
| T16 | PMMA |
| | WAX |
| | Zr |

1.5 mm Ø 3 mm

up to 15 mm ↑

Blades

Art.-No. 526016 1503

T31 - 3.0 | 3.0 mm
shaft milling tool (single blade, slide coated)

| | |
|-----|------|
| T31 | PMMA |
| | WAX |
| | Zr |

3.0 mm Ø 3 mm

up to 30 mm ↑

Blade

Art.-No. 526012 3003

T2/T7 - 2.0 | 3.0 mm
radius milling tool (l = 12 mm)

| | |
|----|------|
| T2 | Ti |
| T7 | CoCr |

2.0 mm Ø 3 mm

up to 15 mm ↑

Blades

Art.-No. 526029 2003

T12 - 1.0 | 3.0 mm
radius milling tool (single blade, slide coated)

| | |
|-----|------|
| T12 | PMMA |
| | WAX |
| | PEEK |

1.0 mm Ø 3 mm

up to 25 mm ↑

Blade

Art.-No. 526004 1003c

T19 - 0.5 | 3.0 mm
shaft milling tool (l = 4 mm), universal

| | |
|-----|-----------|
| T19 | UNIVERSAL |
|-----|-----------|

0.5 mm Ø 3 mm

up to 15 mm ↑

Blades

Art.-No. 526001 0503

T32 - 0.6 | 3.0 mm
radius milling tool long (l = 12 mm)

| | |
|-----|------|
| T32 | PMMA |
| | WAX |
| | Zr |

0.6 mm Ø 3 mm

up to 25 mm ↑

Blades

Art.-No. 526012 0603

T3/T8 - 1.5 | 3.0 mm
radius milling tool (l = 12 mm)

| | |
|----|------|
| T3 | Ti |
| T8 | CoCr |

1.5 mm Ø 3 mm

up to 15 mm ↑

Blades

Art.-No. 526029 1503

T12/T14 - 1.0 | 3.0 mm
radius milling tool

| | |
|-----|------|
| T12 | PMMA |
| | WAX |
| T14 | Zr |

1.0 mm Ø 3 mm

up to 25 mm ↑

Blades

Art.-No. 526016 1003

T20 - 0.6 | 3.0 mm
radius milling tool (conical)

| | |
|-----|------|
| T20 | Ti |
| | CoCr |

0.6 mm Ø 3 mm

up to 15 mm ↑

Blades

Art.-No. 526003 0603

T33/T43/T53 - 0.3 | 3.0 mm
radius milling tool (conical)

| | |
|-----|------|
| T33 | PMMA |
| | WAX |
| | Zr |
| T43 | SINT |
| T53 | COMP |

0.3 mm Ø 3 mm

up to 25 mm ↑

Blades

Art.-No. 526016 0303

T4/T9 - 1.0 | 3.0 mm
radius milling tool (l = 9 mm)

| | |
|----|------|
| T4 | Ti |
| T9 | CoCr |

1.0 mm Ø 3 mm

up to 15 mm ↑

Blades

Art.-No. 526029 1003

T13/T40/T50 - 2.5 | 3.0 mm
radius milling tool (diamond coated)

| | |
|-----|------|
| T13 | Zr |
| T40 | SINT |
| T50 | COMP |

2.5 mm Ø 3 mm

up to 25 mm ↑

Blades

Art.-No. 526013 2503

T21 - 2.5 | 3.0 mm
radius grinding tool (diamond)

| | |
|-----|----------------|
| T21 | glass ceramics |
|-----|----------------|

2.5 mm Ø 3 mm

up to 15 mm ↑

Blades

Art.-No. 526005 2503

T98 - 2.5 | 3.0 mm
shaft milling tool (l = 20 mm, three blades)

| | |
|-----|---------|
| T98 | CALIBR. |
|-----|---------|

2.5 mm Ø 3 mm

up to 20 mm ↑

Blades

Art.-No. 526024 2503

T5/T10/T17 - 1.5 | 3.0 mm
shaft milling tool (l = 15 mm), universal

| | |
|-----|------|
| T5 | Ti |
| T10 | CoCr |
| T17 | PMMA |
| | WAX |
| | Zr |

1.5 mm Ø 3 mm

up to 25 mm ↑

Blades

Art.-No. 526001 1503

T14/T41/T51 - 1.0 | 3.0 mm
radius milling tool (diamond coated)

| | |
|-----|------|
| T14 | Zr |
| T41 | SINT |
| T51 | COMP |

1.0 mm Ø 3 mm

up to 25 mm ↑

Blades

Art.-No. 526013 1003

T22 - 1.0 | 3.0 mm
radius grinding tool (diamond)

| | |
|-----|----------------|
| T22 | glass ceramics |
|-----|----------------|

1.0 mm Ø 3 mm

up to 15 mm ↑

Blades

Art.-No. 526005 1003

T11 - 2.5 | 3.0 mm
radius milling tool (single blade, slide coated)

| | |
|-----|------|
| T11 | PMMA |
| | WAX |
| | PEEK |

2.5 mm Ø 3 mm

up to 25 mm ↑

Blade

Art.-No. 526004 2503c

T15/T42/T52 - 0.6 | 3.0 mm
radius milling tool (conical)

| | |
|-----|------|
| T15 | PMMA |
| | WAX |
| | Zr |
| T42 | SINT |
| T52 | COMP |

0.6 mm Ø 3 mm

up to 25 mm ↑

Blades

Art.-No. 526016 0603

T23 - 0.6 | 3.0 mm
radius grinding tool (conical, diamond)

| | |
|-----|----------------|
| T23 | glass ceramics |
|-----|----------------|

0.6 mm Ø 3 mm

up to 15 mm ↑

Blades

Art.-No. 526005 0603

CORiTEC Materials

CORiTEC ZR (ZIRCONIUM DIOXIDE)

Covers all indications for dental restorations of up to 16 units. Ideally suited for monolithic restorations.

- highly translucent zirconium dioxide for natural esthetics
- increased strength compared to lithium dioxide

Zr ht+ Disc
(highly translucent)



Zr Disc



Zr transpa Disc



Zr transpa Disc
(pre-colored translucent)



CORiTEC ZR (ZIRCONIUM DIOXIDE)

- single crowns
- single cap
- bridges up to 16 units, full bridges, and PFM technology

- good mechanical properties
- good milling properties
- corrosion resistant

CoCr Disc
(non-precious alloy)



CoCr Mo Disc
(non-precious alloy)

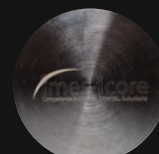

Ti Disc
(Grad 2, Grad 4, Grad 5)



JUVORA PEEK (POLYETHERETHERKETONE)

- clamp-retained constructions
- Juvora PEEK in its basic colour (brown-beige)
- highest biological compatibility



CORiTEC WAX DISC (WAX, GRAY)

CORiTEC Wax Disc is not suitable for intraoral application. After milling, the material can be used as lost wax. Moulds can be used in casting technology. It can be milled easily and combusted residue-free.



CORiTEC PMMA (POLYMETHYL METHACRYLATE)

- bite guards, therapeutic splints, drilling templates, bite regulators
- very good mechanical properties
- aesthetic shade effect due to high translucency
- good milling behaviour

PMMA Splint Disc



PMMA Disc



CORiTEC MODEL DISC IVORY

- blank for the production of dental models
- low-cost material
- also suitable for test purposes or for milling calibration bodies



CORiTEC SmartControl™

SMART CONTROL OF MACHINE SOFTWARE

SmartControl™ one touch ahead!

The newly developed control software „SmartControl™“ provides absolutely intuitive operation of our milling machines. From selecting the job to milling or querying the machine status; the self-explanatory and optimized handling makes it possible to start operating the machine in the shortest possible time. Starting a milling process requires only two clicks – benefit from the smart time savings for your workflow!

FEATURES

- Modern touch control design
- Easiest operation through intuitive graphical user interface
- High end performance for imes-icore® machines
- Remote monitoring
- Job management with 3D preview
- Multi-language support*

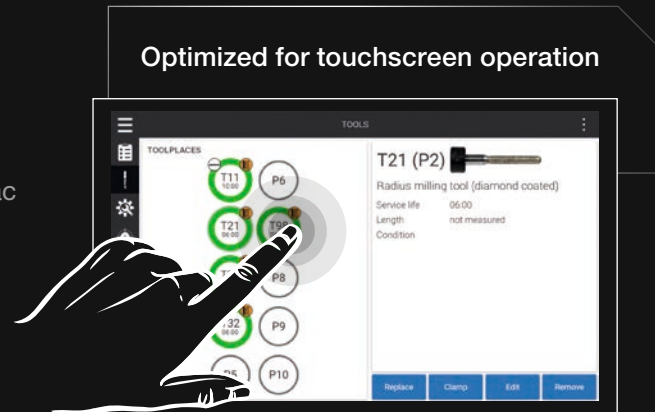

Optimized for touchscreen operation

Automated transfer of information from the CAM software



Ideal tool management

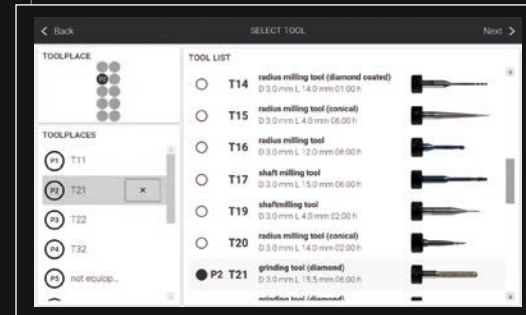

Scanner COMPATIBLE WITH exocad

CORiTEC i3Dscan eco

- all-round carefree package for newcomers or small laboratories
- simple, fast, low-priced
- very compact design



CORiTEC i3Dscan color

- the object to be scanned is automatically guided into the measuring field
- modern touch control design
- the 180-degree opening offers a large working area



CORiTEC i3Dscan color HR

- enormously high scanning efficiency and precision (4 µm)
- color texture scan
- Blue-Light LED & high resolution camera (2.8 MP)
- all modules included in the scope of delivery

CAM software

CORiTEC iCAM V5 smart

- all strategies optimized for 5-axis simultaneous machining
- automatic exchange of implant connections (ReFit option)
- no annual license fees
- fully automatic and easy operation with “Wizard Workflow“



CORiTEC iCAM HD compact

- hyperDENT based CAM software
- flexible payment model (purchase or subscription model)
- three months free use with CORiTEC 150i machine purchase

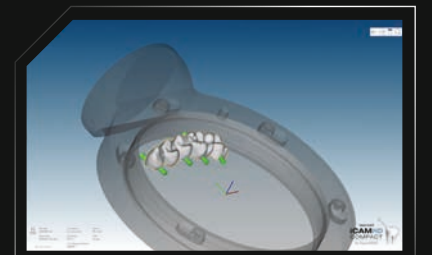

*in preparation

Full integrated workflow

OPEN TO ALL COMMON SCANNERS

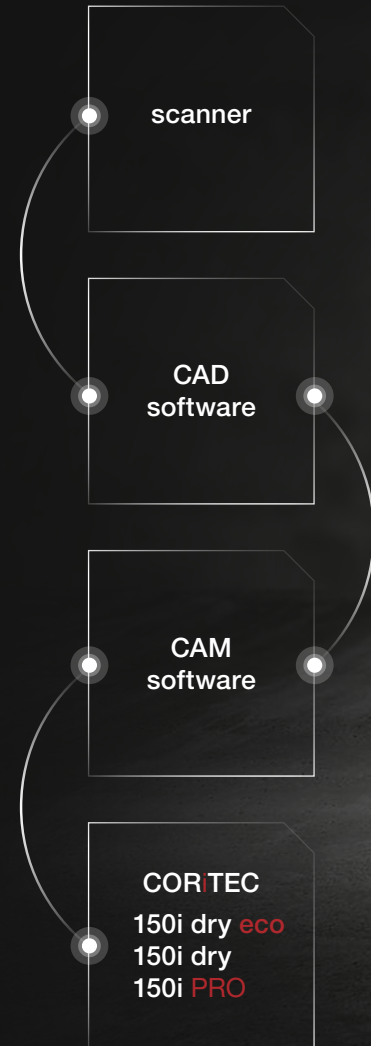

Applications & holders

HALF-OPEN BLANK HOLDER (C-CLAMP)

- enables 5-axis machining up to 90 degrees axis adjustment
- extension of the technical possibilities of your milling machine



UNIVERSAL HOLDER FOR TURN-MILL-GRINDING PROCESSING

- high precision
- improved surface quality
- tool-saving machining



PREFABRICATED ABUTMENTS

- short production times
- production of abutments in very simple processes
- high accuracy of fit due to prefabricated implant interface

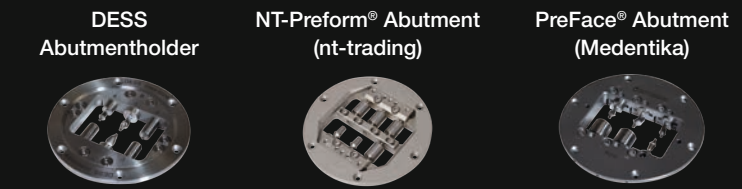

THERAPEUTIC SPLINTS

- bite splints, bleaching splints
- snoring splints, aligners
- simple and high-quality implementation in CAD/CAM processes



GRINDING OF CAD/CAM BLOCKS

- new 6-fold adapter enables effective production
- exchangeable strips for different adapter systems
- crowns, onlays, inlays, veneers, bridge frameworks, etc.



MILLING OF MODEL CASTS

- production in combustible materials (PEEK)
- allergy-free and lightweight model casting when using PEEK
- cost-efficient

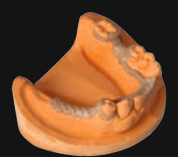

Sintering furnaces

iSINT eco

The **iSINT eco** stands for economy and offers high-quality technology, matching accessories for high standards at a fair price. Compact and with a small footprint, the **iSINT eco** sintering oven still has sufficient capacity for a sintering bowl Ø100 mm for approx. 25 units. The door stop can be mounted at the right or left side.

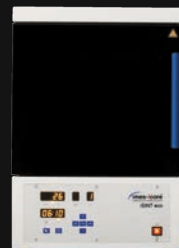

iSINT PRO

A larger sintering capacity of up to 80 single crowns is offered by the new **iSINT PRO**. With a heating system of four high-quality molybdenum disilicide (MoSi₂) heating elements, you can choose between conventional long-term sintering or SPEED sintering at a rate of up to 90 °C/min/210.20 °F/min. The **iSINT PRO** is operated with a simple and convenient program control. The programs are indicated on a 4-line LCD display. A timer function for overnight sintering or the use of pre-drying programs for shaded zirconium restorations offer further options. In addition, three service programs are available for easy maintenance of the sinter furnace.

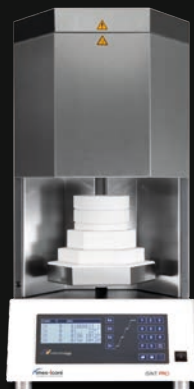

| | iSINT eco | iSINT PRO |
|-----------------------------|-----------------------|---------------------------|
| Number of heating elements | 4 | 4 |
| Display | 7-Segment | 4-line LCD |
| Number of program memories | 9 | 30 |
| Combustion chamber capacity | 1 x 100 | 2 x 120 |
| max. heating rate | 30 °C/min / 86 °F/min | 99 °C/min / 210.20 °F/min |
| Power in W | 1300 | 3200 |
| Lift function | No | Yes |
| Speedsintering | No | Yes |

Suction system

iVAC silent & iVAC silent PRO

The system is equipped with a teflon filter cartridge, automatic filter cleaning and a dust drawer. With the suction power of 160m³/h the iVAC silent is perfectly suited for your CORITEC 150i and is even stowable in the optional machine table.



| | iVAC silent | iVAC silent PRO |
|------------------------|--|--|
| airflow | 160 m ³ /hr | 240 m ³ /hr |
| power | 490 W | 1610 W |
| filter system | Teflon filter cartridge, automatic cleaning feature | Teflon filter cartridge, automatic cleaning feature |
| filter volume | 8 liters/30.28 gpm (dust drawer) | 8 liters/30.28 gpm (dust drawer) |
| width x depth x height | 9.6 x 19.6 x 17.3 inch / 245 x 500 x 440 mm | 10.6 x 21.2 x 21.1 inch / 270 x 540 x 535 mm |
| supply voltage | 230 V | 115 V/230 V |
| special features | suitable for machine tables T0, T1 and T2, quiet running, very compact, self-cleaning by vibration | suitable for machine tables T1 and T2, quiet running, very compact, self-cleaning by vibration |



Machine table

MACHINE TABLE T0

The machine table T0 is exactly adapted to the CORITEC 150i series by its dimensions 422 x 540 x 900 mm / 16.6 x 21.3 x 35.4 inch (W x D x H).

Dimensions

CORiTEC 150i series

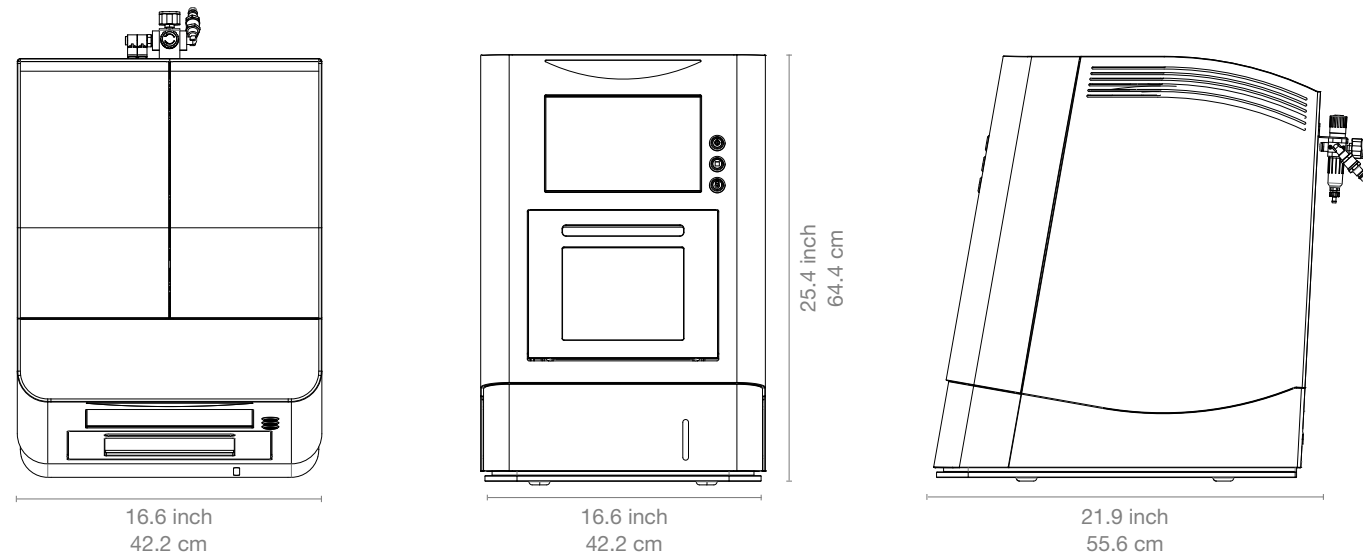

Machine table T0

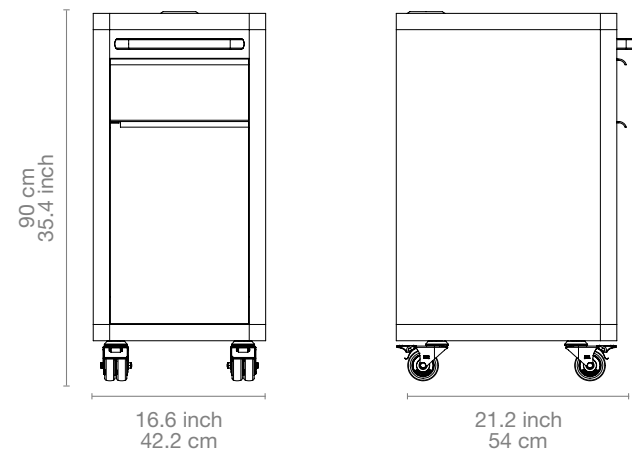

In numbers

| mechanics/electronics | |
|-----------------------------------|--|
| number of axes and operation type | 5 axes, simultaneous processing |
| rotation angle | A-axis 360°, B-axis 130° |
| spindle / power | high-frequency spindle / 750 W |
| maximum spindle speed | 100.000 rpm |
| tools | milling and grinding tools with 3 mm tool shaft |
| tool changer | 10-fold |
| tool length control | ≤ 0.002 mm precision |
| integrated PC | Windows based |
| monitor | integrated 10"1" touchscreen (CORiTEC 150i dry & 150i PRO) |
| illumination | 3 LED status colors |
| software | SmartControl™ integrated CNC software |
| air pressure | 3 bar/43.5 PSI, 50l/min/189.25 gpm/min |
| cooling liquid | 3 liter/11.36 gpm integrated |
| connecting requirements | |
| weight | 75 kg / 165.38 lbs |
| width x depth x height | 16.6 x 21.9 x 25.4 inch / 422 x 556 x 644 mm |
| line voltage/frequency | 100 V - 240 V/50/60 Hz |

Sales and support partner worldwide



Represented for you in over 100 countries.

imes-icore® GmbH has been a leading manufacturer and technology partner since 2003 in the field of dental CAD/CAM systems and solutions.

With its unique range of dental milling and grinding systems, imes-icore® offers a perfect selection for all individual requirements of dental laboratories, milling centres and dental practices of all sizes.

Our “Open-System” product philosophy makes it possible to easily integrate our milling machines into your existing workflow and to integrate them with your open scanners and your CAD/CAM software. We are open for your material selection.

imes-icore® GmbH

Fon +49 (0) 66 72/898 228

Fax +49 (0) 66 72/898 222

dental@imes-icore.de